

Flange NO 80, NP 16

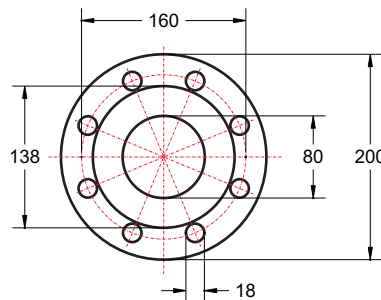

Flange on request :

- NO 80, NP 6
- NO 100, NP 6
- NO 100, NP 16

Pump Type	Elektromotor				L mm	Mass kg
	Type	kW	A	r.p.m		
NCP 80-1A	1ZK 90 S4	1,1	2,8	1420	467	50
NCP 80-1	1ZK 80 B4	0,75	2,1	1400	446	46
NCP 80-2	1ZK 80 B4	0,75	2,1	1400	446	46
NCP 80-3	1ZK 80 A4	0,55	1,7	1380	446	45

Comprex NCP80 - 1450 r.p.m

Temperature Range : -20 to +140 °C

System pressure: NP 6 (bar)

Materials:

For temperatures up to + 90 °C:

Cast iron, stainless steel

Mechanical seal: Carbon / Ceramic.

For temperatures above +90 °C:

Cast iron, stainless steel and bronze.

Mechanical seal: SiC / SiC / Viton.

Allowed fluids:

Domestic or industrial water without abrasive

Heating water to VDI 2035

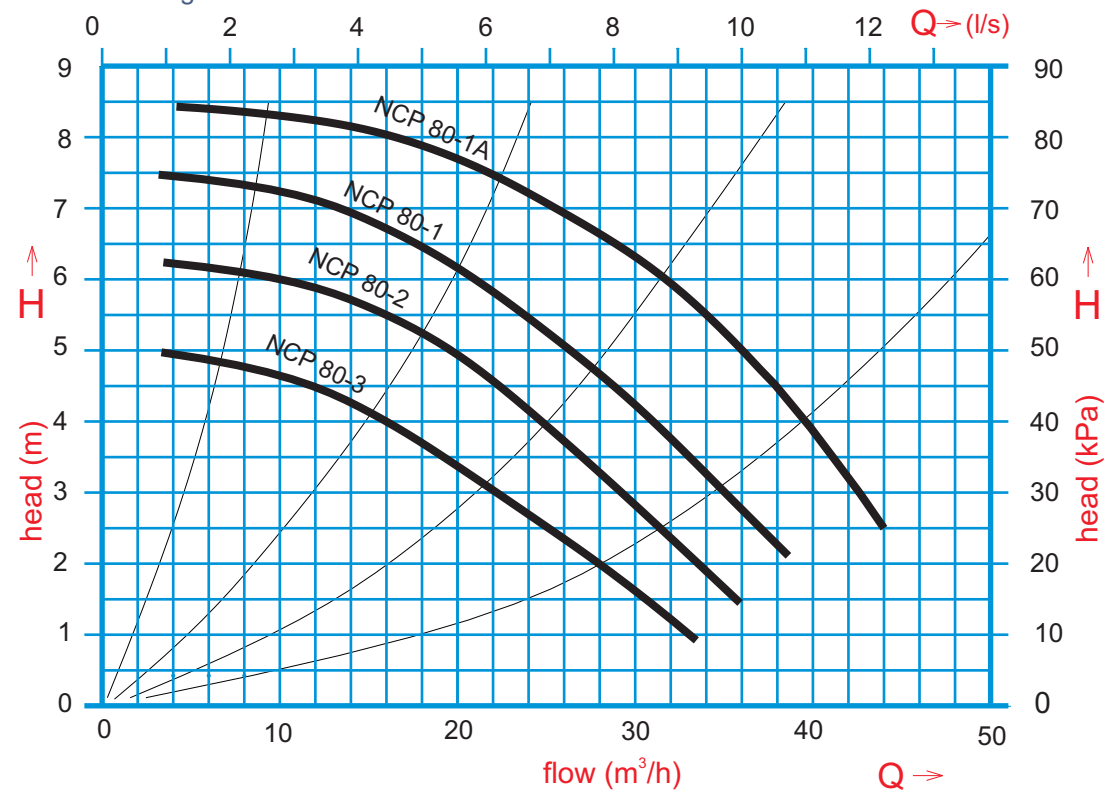

Type testing of pumps is made at the Institute for Hydraulic Machines faculty of Mechanical Engineering in Belgrade, in accordance with the recommendations of DIN 1944 and ISO 2548th. Report number: 06-01-03/95